

## D-RRU-UT12

D-RRU-UT12 is for use under RRU's and antennas to support jumpers and prevent extreme wind and weather from compromising connections. The D-RRU-UT12 mounts on 1-1/2" OD to 3-1/2" round members with 1/2" clamps, and the standoff length is adjustable. The D-RRU-UT12 can accept hangers with 3/8" and 3/4" connections.

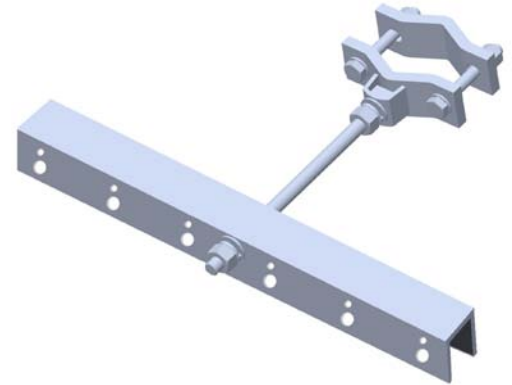

## General Specifications

<b>Stand Off</b>	< 12"
<b>Round Member Size</b>	1-1/2" to 3-1/2" OD
<b>Number of Runs</b>	Up to 12
<b>Material</b>	Galvanized Steel
<b>Weight</b>	9.5 lbs

## Kit Components

<b>(1) SAM-SCP.01</b>	1/2" Sam Mounting Clamp with U-Clip
<b>(1) SCP</b>	1/2" Thick Bent Clamp Half
<b>(2) GR12-6</b>	1/2" Galvanized Threaded Rod
<b>(4) 12NA</b>	1/2" Galvanized HD Nut
<b>(4) 12LW</b>	1/2" Galvanized Lock Washer
<b>(4) 12FW</b>	1/2" Galvanized Flat Washer
<b>(1) GR58-10</b>	5/8" x 10" Galvanized Threaded Rod
<b>(1) 58SJN</b>	5/8" Square Jam Nut
<b>(3) 58NA</b>	5/8" Heavy Duty Nut
<b>(3) 58LW</b>	5/8" Lock Washer
<b>(3) 58FW</b>	5/8" Flat Washer
<b>(1) RRU-UT12.02</b>	Star Support Bracket for 12 Runs, Custom Punched for 5/8" Rod